

# Ultra Slim Multipurpose Power Amplifier **Powerstick**



The Powerstick is a ultra slim, lightweight 2 x 500 W power amplifier with integrated DSP controller. It is intended for the integration into the Monopod of the L-Series, but it can also be mounted directly on the backside of an L-Series loudspeaker. Due to its design, it can also be integrated in truss constructions or exhibition stands.

## PRODUCT SPECIFICATIONS

<b>Model</b>	Powerstick
<b>Description</b>	Ultra Slim Multipurpose Power Amplifier
<b>Power</b>	2 x 500 Watt (< 1% distortion @ 1kHz)
<b>Maximum Input</b>	+ 21 dB
<b>DSP</b>	32 bit risc
<b>Presets</b>	2 x 4
<b>Signal/Noise Ratio</b>	115 dB
<b>Latency</b>	1.54 ms
<b>Inputs</b>	2 x XLR in / loop thru
<b>Outputs</b>	2 x Speakon
<b>Power Consumption</b>	Max. 500 Watt average
<b>Mains Supply</b>	110-230 VAC
<b>Weight</b>	2,6 kg
<b>Size</b>	508 x 85 x 82 mm
<b>Order No.</b>	<b>00750/dp</b>



Powerstick +  
Monopod,  
Design L 16j

**The Powerstick features integrated digital amplifier electronics with a DSP controller. Various factory-configured presets and volume settings can be selected.**

High-grade electronic components from the industrial sector and a first-class circuit design ensure excellent audio quality with low distortion and effectively minimise static noise. The optimized limiters protect the speakers from overpowering.



**Speaker out - 1**  
For connection of HiMid systems.  
Amplifier channel 1 (Pin 1+/-)

**Speaker out - 2**  
For connection of HiMid systems.  
Amplifier channel 2 (Pin 1+/-)

**XLR**  
Symmetrical analog input  
Max. Input +21dBu  
HF- and DC-filter.  
Virtual ground lift.

**Level**  
Adjustment in 3 dB steps  
(-6 dB to +3 dB).

**Mute LED**  
Red light when the system is muted or under technically crucial conditions.

**Limit LED**  
Yellow light when the limiter is restricting the level.

**Signal LED**  
Green light when the input signal exceeds -20 dBu.

**Power LED**  
Green light when the system is switched on.

**PowerCon (blue)**  
Power supply  
195-250 VAC.

**Speaker out - 2**  
For connection of the subwoofer (Pin 2 +/-) and HiMid (Pin 1 +/-)

**Presets Bank No. 1**

- No. 1 - 2 x L 16j (HP 150)**  
Preset for 2 x L 16j / i with high pass filter at 150 Hz
- No. 2 - 2 x L 16j (HP 200)**  
Preset for 2 x L 16j / i with high pass filter at 200 Hz
- No. 3 - L 16j + G Sub 1201**  
2-way preset for one L 16j / i in combination with up to two G Sub 1201
- No. 4 - L 16j + G Sub 1501**  
2-way preset for one L 16j / i in combination with up to two G Sub 1501

**Presets Bank No. 2**

- No. 1 - 2 x Flat**  
Flat preset with high pass filter at 50 Hz. For loudspeakers which don't require further signal processing.
- No. 2 - 2 x Boost**  
Same as No. 1 with additional bass boost (60 Hz Q2 + 6 dB)
- No. 3 - Top / Sub 120**  
2-way preset with 120 Hz crossover frequency for a combination of HiMid systems and subwoofers.
- No. 4 - Top / Sub 180**  
2-way preset with 180 Hz crossover frequency for a combination of HiMid systems and subwoofers.

**Mode - key**  
Changing to control modes  
Status / Level and Presets.

**Set - key**  
Setting of various values and Mute on / off.

## ACCESSORIES Powerstick

### Monopods for L-Serie

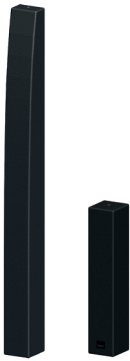

Size and Design like L 16j,  
to be fixed with M20 on bottom  
and M10 on top  
Order No. **00750/L16j**

Size and Design like L 8i,  
to be fixed with M20 on bottom  
and M10 on top  
Order No. **00750/L8i**

### Universal Bag



Universal bag for  
Small Base Plate and accessories,  
with side pocket  
51 cm x 62 cm x 23 cm  
(height x width x depth)

Order No. **01227**

### Tool Set for Monopod



consisting of: wooden plate  
with M20 and M10 screws,  
matching keys, magnetic bits

Order No. **00750/tool**

### Small Base Plate

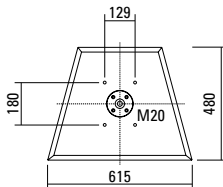

61,5 x 48,0 cm  
with M20 flange

Order No. **01278/M20**

### XL Base Plate

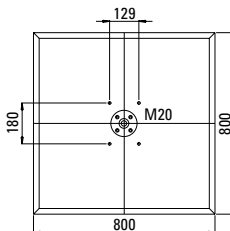

80,0 x 80,0 cm  
with M20 flange

Order No. **01279/M20**

### Hybrid Cable System



PowerCon-PowerCon / XLR-XLR

2,5 m    Order No. **08462**  
5 m      Order No. **08464**  
10 m     Order No. **08466**  
15 m     Order No. **08468**

